

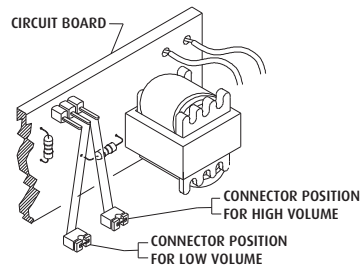

**Safety Technology International**  
 2306 Airport Road • Waterford, Michigan 48327-1209  
 Phone: 248-673-9898 • Fax: 248-673-1246  
 Toll Free: 800-888-4784 • E-mail: info@sti-usa.com  
 Web: www.sti-usa.com

**Safety Technology International Ltd**  
 Taylor House • 34 Sherwood Road • Bromsgrove  
 Worcestershire • B60 3DR • England  
 Tel: +44 (0)1527 520 999 • Fax: +44 (0)1527 501 999  
 E-mail: info@sti-emea.com • Web: www.sti-emea.com

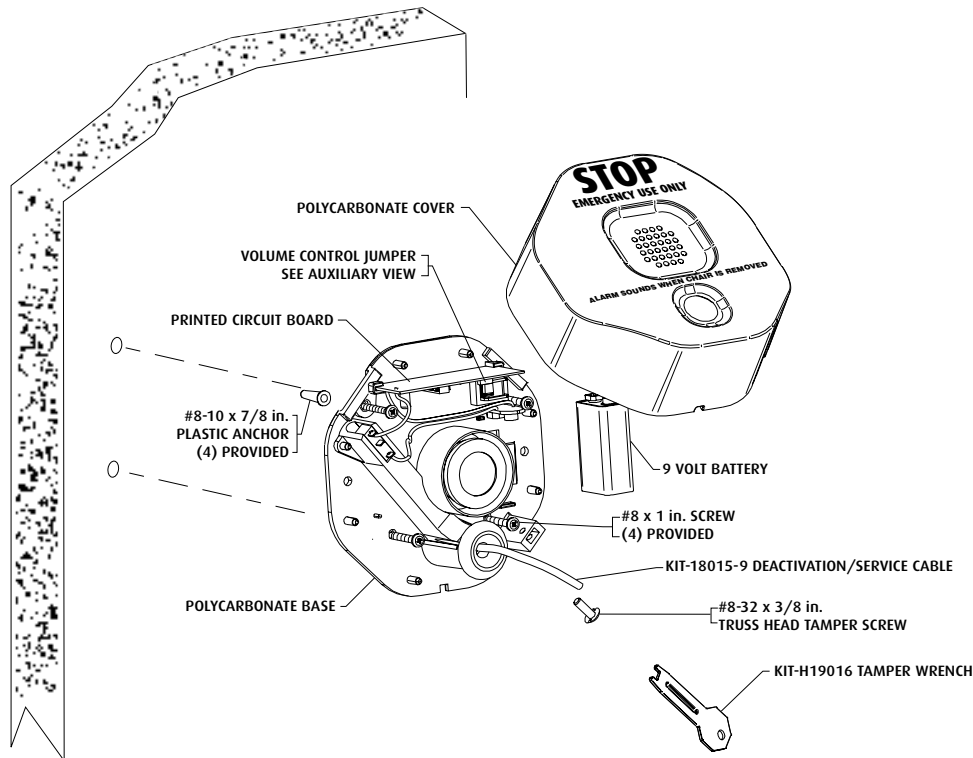

VIEW SHOWING JUMPER LOCATION  
FOR VOLUME SETTINGS

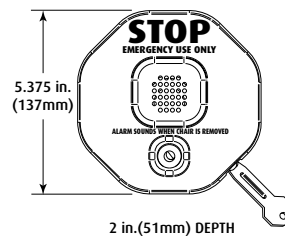

PRODUCT DIMENSIONS

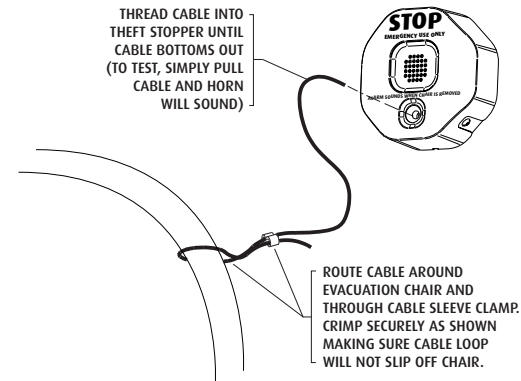

**NOTE: PLACE CABLE IN A SECURE LOCATION  
TO ASSURE IT WILL NOT IMPEDE  
PROPER USE OF EVACUATION CHAIR.**

**WARNING:** This product can expose you to chemicals including Bisphenol A, which is known to the State of California to cause reproductive harm and Dichloromethane, which is known to the State of California to cause cancer. For more information go to [www.P65Warnings.ca.gov](http://www.P65Warnings.ca.gov).

Three year warranty or a one year limited warranty (from date of purchase) on most products. See website for details. Electronic warranty form at [www.sti-usa.com/wc14](http://www.sti-usa.com/wc14).

## INSTALLATION OF STI-6202 EMERGENCY CHAIR THEFT STOPPER®

All specifications and information shown were current as of publication and are subject to change without notice.

6202IS NOV2013