

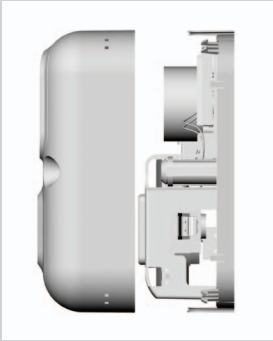

**Safety Technology  
International, Inc.**

## Alert Point Lite



### INSTALLATION INSTRUCTIONS

#### Features

- Aesthetically pleasing, integral self-contained sounder and resettable call point.
- Ideal solution for establishments requiring a simple, cost effective way of raising an alarm in the event of an emergency.
- Constructed of tough polycarbonate material.
- When activated, a warning indicator drops into view and the 95 or 120 dB alarm will sound.
- Powered with a 9V DC alkaline battery.
- Has seven different selectable alarm tones.
- Four alarm conditions are available: 30 seconds, 3 minutes, 20 minutes or continuous.
- May be linked with other units (including the Alert Point). When activated, it will trigger the linked units causing them to also activate.
- Quick and easy to install, it provides protection within minutes.
- Housing available in red, blue, green or white.
- Designed for use in industrial, commercial and retail applications.
- Can be used for a wide range of applications such as: fire, intruder, panic, evacuation, assist or general alarm.

**We protect the things that protect you.®**

# Installation of the unit

## 1. Mounting Plate Orientation

The reversible mounting plate can be installed in any orientation; depending on the required conduit entry and exit points.

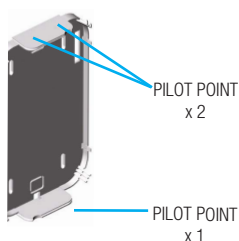

## 2. Attach Mounting Plate

Mark the 4 fixing points (as shown) and install using the screws and Rawlplugs provided.

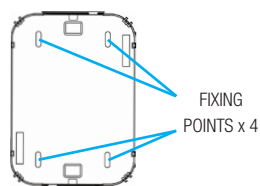

## 3. Attach the Chassis

Attach by pushing the chassis over the 4 fixing clips on the mounting plate (highlighted).

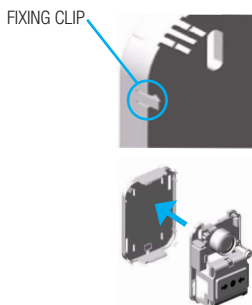

## 4. Attach the Front Cover

Note: Consult *Programmable Features* section prior to *Front Cover Installation*. Line up each end using the channels located on the raised conduit sections (see detail) then push evenly until the cover locks into place via 4 raised mounting clips situated on each corner.

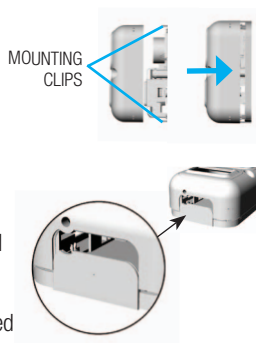

# Basic operations

## 1. Turn the Unit "ON"

Using the master key, turn the key switch cylinder to the vertical position.



## 2. Test the Unit

Depress the operating element. A warning indicator drops into view, the unit will alarm.

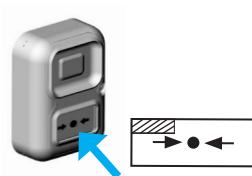

## 3. Reset the Unit

Insert the reset key into the bottom of the Alert Point:Lite. A quick counter-clockwise turn of the key and the unit is reset, returning to "standby" condition and is ready for use.



## 4. Removing the Front Cover

Using the 2 pips on the reset key provided, push firmly into each of the 4 corner clips individually, releasing them, while at the same time, gently pulling the cover away from the mounting plate.

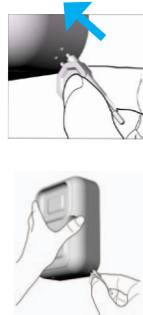

## Programmable Features

### Integral Sounder Tones (DIP Switch No. SW1-SW3)

The Alert Point Lite has seven different selectable alarm tones ranging from 95 to 102dB.

### Sounder Timer Options (DIP Switch No. SW5 & SW6)

Four alarm conditions are available and can be selected by changing the DIP switch settings. These are: 30 seconds, 3 minutes, 20 minutes or continuous.

If any duration other than “continuous” is used, the alarm will silence after the selected time has elapsed.

This alarm will NOT be able to be reactivated until the unit is reset with the reset key.

### Key Switch – Reset (DIP Switch No. SW7)

This allows the user greater control if misuse becomes a major factor.

**SW7 position - ON:** The Alert Point Lite will fully reset after activation when using the reset key.

**SW7 position - OFF:** Even if the Alert Point Lite is reset after activation using the reset key, all sounders will continue to run until the unit is reset using the master key switch.

## DIP Switch Settings

**Important:** Changes to any DIP Switch settings will only take effect after the Alert Point Lite has been reset using the master key switch (turn “OFF” then back “ON”).

FEATURES	DIP SWITCH SETTING				ACTION
<b>Integral Sounder Alarm Tone</b>	<b>SW1</b>	<b>SW2</b>	<b>SW3</b>	<b>Tone</b>	<b>Sound Pattern</b>
	OFF	OFF	OFF	1	800Hz - 970Hz (Sweep)
	ON	OFF	OFF	2	800Hz - 970Hz (Sweep)
	OFF	ON	OFF	3	988Hz / 250ms - 645Hz / 250ms (Alternating)
	ON	ON	OFF	4	670Hz / 250ms - 845Hz / 370ms (Alternating)
	OFF	OFF	ON	5	800Hz - 970Hz in 350ms (Sweep)
	ON	OFF	ON	6	2400Hz - 2850Hz in 110ms (Sweep)
	OFF	ON	ON	7	2400Hz - 2850Hz in 330ms (Sweep)
	ON	ON	ON	8	Not implemented
	<b>SW4 ON</b>			Not used	
	<b>SW4 OFF</b>			Not used	
<b>Sounder Duration Timer</b>	<b>SW5</b>	<b>SW6</b>	<b>Sounder Duration</b>		
	OFF	OFF	Sounders run continuously (until manually reset)		
	ON	OFF	Sounders switch off automatically after 30 seconds		
	OFF	ON	Sounders switch off automatically after 3 minutes		
	ON	ON	Sounders switch off automatically after 20 minutes		
<b>Reset</b>	<b>SW7 ON</b>			Alert Point Lite returns to “standby” condition after resetting with reset key.	
	<b>SW7 OFF</b>			Alert Point Lite latches in “alarm” condition until it is manually reset using the master key switch.	
<b>Networking the Alert Point Lite</b>	<b>SW8 ON</b>			The Alert Point Lite expects to be connected to another Alert Point Lite, otherwise a warning beep is emitted.	
	<b>SW8 OFF</b>			No fault will be indicated if an Alert Point Lite is not connected to another Alert Point Lite, it is not looking for a connection.	

## Other Features

### Integral Sounder Volume

The Alert Point Lite has two volume settings, High & Low; this is determined by the position of the jumper connector configuration shown below.

**High Volume:** Jumper between center pin and bottom pin (factory setting).

**Low Volume:** Jumper between center pin and top pin

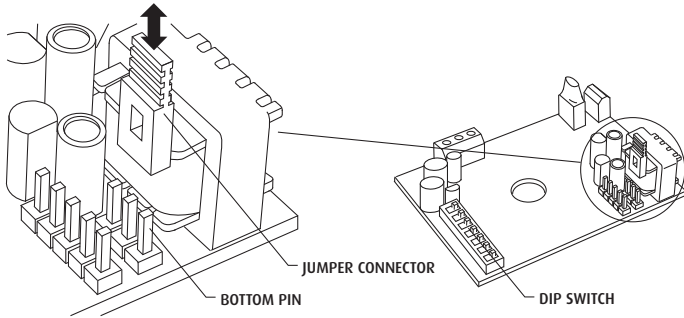

### Battery

The Alert Point Lite monitors the output power of the 9V DC battery and emits a periodic (single) beep if the battery falls below the recommended power level. The working life in "standby" condition is a minimum of 15 months: it is recommended that this battery is replaced at least every 15 months.

### Networking only 2 units (Diagram 1) front covers are removed

1. Be sure that both units are switched "OFF" and front covers are removed.
2. DIP switch SW8 should be "ON" on both units (each unit expects to be connected to a 2nd unit).
3. Unit #1: Insert wires into the network terminals as shown opposite.
4. Unit #2: When connecting into the network terminals, ensure that the "Network In" and the "Network Out" wires are switched over (as shown in diagram 1).
5. Turn both units "ON" using the master key switch.

### TEST

6. **Unit #1**, press the operating element. This will send the unit into alarm condition, causing the activation flag to drop into view and the alarm to sound.  
**Unit #2** will also immediately trigger into alarm.
7. Resetting the networked units can only be done by manually resetting the originally activated unit using the reset key (showing the activation flag, in this case unit #1).
8. Repeat the above test in reverse by activating the 2nd unit.

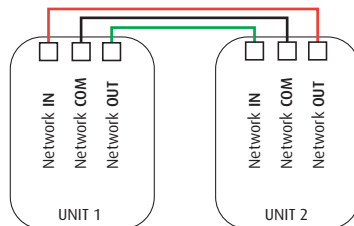

Diagram 1

## Networking 3 or more units (Diagram 2) front covers are removed

1. Be sure all units are switched "OFF" and front covers are removed.
2. DIP switch SW8 should be "ON" on all the units (each unit expects to be connected to another unit).
3. Connect the "Network COM" terminals by inserting a wire into unit #1, and linking this to the same terminal on unit #2. Now do the same by connecting an additional wire to the "Network COM" terminal on unit #2, and linking this to the same terminal on unit #3. Repeat this for subsequent units until all units are linked.
4. Insert a wire into the "Network Out" terminal on unit #1, and link this to the "Network In" terminal on unit #2. Now insert a wire into the "Network Out" terminal on unit #2 and link this to the "Network In" terminal on unit #3. Repeat this step for each subsequent unit.
5. Important! On the final unit (e.g. unit #3) ensure that the "Network Out" terminal is linked back to the "Network In" terminal on unit #1, creating a loop. (It is not necessary to do this step for the COM wire.)
6. Turn all the units "ON" using the master key switch.

### TEST

7. Unit #1, depress the operating element. This will send the unit into alarm condition, causing the activation flag to drop into view and the integral alarm to sound. Unit #2 & unit #3 will also immediately trigger into alarm.
8. Resetting the networked units can only be done by manually resetting the originally activated unit (showing the activation flag, in this case unit #1) using the reset key. This will return the other units back into "standby" condition.

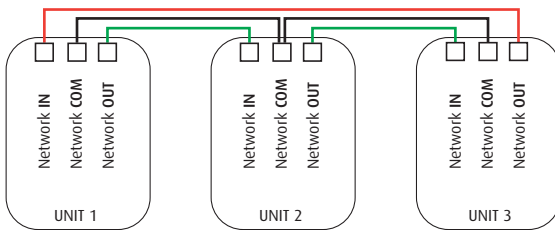

Diagram 2

## Loss of Connection between Units

**Any loss of connection within the network will indicated as a fault (double beep every 90 seconds) this will only be indicated on the unit expecting the input signal.**

In Diagram 3, the “Network IN” connection is lost on unit #2, Resulting in:

- 1: **Unit #2** – a warning double beep will be emitted every 90 seconds.
- 2: **Unit #1** – will not be able to trigger unit #2 into alarm condition, the signal is lost to the “Network IN” connection on unit #2.
- 3: **Unit #2** – can still trigger unit #1 into alarm condition as the connection remains intact between the “Network OUT” on unit #2 and the “Network IN” on unit #1.
- 4: **Both units** – will continue to work independently.
- 5: **Unit #2** – will instantly return to its “standby” condition when the connection is remade, without\* having to reset the unit.

**\*Note:** to check that the network is functioning correctly, while avoiding having to wait 90 seconds for verification, turn the unit OFF then back ON using the master key switch (a fault will emit a double beep immediately on startup).

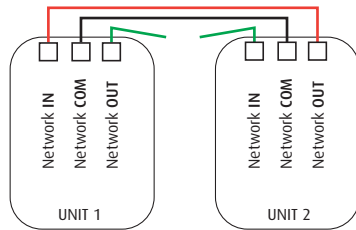

Diagram 3

## Installing External sounders

1. Ensure the unit is switched “OFF.”
2. Insert the external sounders into the correct terminals. (see page 7)

**Important:** Please be sure all sounders have their own power source and are wired in accordance with their own installation manual.

**Warning:** Incorrectly installed external sounders may cause irreversible damage to the Alert Point Lite.

3. Turn the unit “ON” using the master key switch.
4. Test – When the operating element is pressed, the unit will go into alarm condition and the externally installed sounders should now activate.
5. Reset the Alert Point Lite using the reset key; all sounders should now silence.

## General Maintenance

9V DC batteries should be replaced every **15 months** or sooner.

Cleaning should be carried out using only mild, diluted detergents: concentrated solutions and those including (but not limited to) alkalis, strong acids, ethers, amines, aromatic hydrocarbons and alcohols can cause considerable harm to this product.

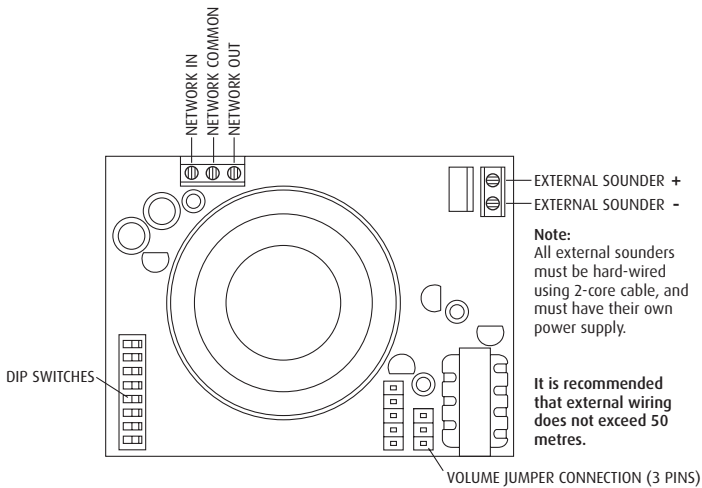

PCB Terminal Diagram

## Specifications

Power source	9V DC battery (included)
Standby current	45µA
Alarm current	28mA (low volume) / 32mA (high volume)
Operating temperature	32° to 120°F (0° to 49°C)
Sounder output (at 1m)	95 – 102dB
Sounder tones	7
Network	>2 units spaced less than 50m apart

## Fault Finding

A simple test completed on each individual unit will immediately highlight if any of the following faults are evident: **Low Battery condition, Network connection loss**

Using the master key, turn the unit “OFF” and then back “ON.”

- If no audible beeps sound within 5 seconds, the unit has no faults.
- If a short single beep sounds within 5 seconds the unit has a low battery fault.  
Replace the battery.
- If 2 short beeps sound within 5 seconds the unit has a network fault. Check all the network cable terminations and/or the wiring associated with the input signal to the device.

## Warranty

Safety Technology International, Inc. warrants to the original consumer/purchaser what this product shall be free of defects in material and workmanship under normal use and circumstances for a period of one (1) year from the original date of purchase.

Electronic warranty form at [www.sti-usa.com/wc14](http://www.sti-usa.com/wc14).





**Safety Technology  
International, Inc.**

2306 Airport Rd • Waterford, MI 48327  
Phone: 248-673-9898 • Fax: 248-673-1246  
info@sti-usa.com • www.sti-usa.com

**Safety Technology International (Europe) Ltd.**

Unit 49G Pipers Road • Park Farm Industrial Estate • Redditch  
Worcestershire • B98 0HU • England  
Tel: 44 (0) 1527 520 999 • Fax: 44 (0) 1527 501 999  
E-mail: info@sti-europe.com • Web: www.sti-europe.com